



**Braunstone Community**  
Primary School

# **BCPS**

## **Full Opening Plan**



**March 8th 2021**

## Introduction

The government has announced that schools will be open to all children on March 8<sup>th</sup> 2021. This document sets out Braunstone Community Primary School's plans for opening the school to **all** children taking into consideration the guidance set out by the DFE.

## Entry and exit to the school grounds.

Entrances have been designated for different year group bubbles of children to ensure that everyone accessing the premises is able to adhere to social distancing rules. **Please support us as a school in keeping everyone safe by:**

- Keeping 2 meters apart (parents and children) both outside the gates and on the school premises.
- Following the one-way system in operation around the school grounds
- Wearing a face covering at all times when on the school premises.

Staff will be heavily involved in ensuring the safety of all people coming onto the school grounds and will direct as necessary. The front car park gate will be closed to cars for the registration period to ensure the safety of the year 6/5/4 pupils coming on site. Entrances designated below:



Please help us and your children to maintain the social distancing at all entrances to the school. There will be markings and signage on the school grounds to help with organisation and distancing.

**Drop-off and Collection Arrangements:**

Children in year 4,5,6 will be encouraged to enter the school independently. If your child needs to be dropped off or collected from school, please make sure that only one adult/carer is with them. Please can we remind you to leave the premises quickly when you have dropped off your child and avoid gathering with others.

Start of the day					End of day			
Entrance	8.30	8.40	8.50	9.20	2.55	3.05	3.15	Exit:
Car Park			Year 6	Registers close			Year 6	N/A
Car Park		Year 5				Year 5		N/A
Car Park	Year 4				Year 4			N/A
Wellinger Way	Year 3				Year 3			WW
Wellinger Way		Year 2				Year 2		WW
Wellinger Way			Year 1				Year 1	WW
Front gate	FSH	FMW				FSH	FMW	
Front gate	F1				F1			WW

**Classrooms**

As soon as children enter the classroom, they will sanitise their hands and continue to do this regularly throughout the day. The plan below shows the location of each classroom. Children will remain in their classrooms for the majority of the day unless they are outside for PE or for indoor PE (mindfulness/Yoga).

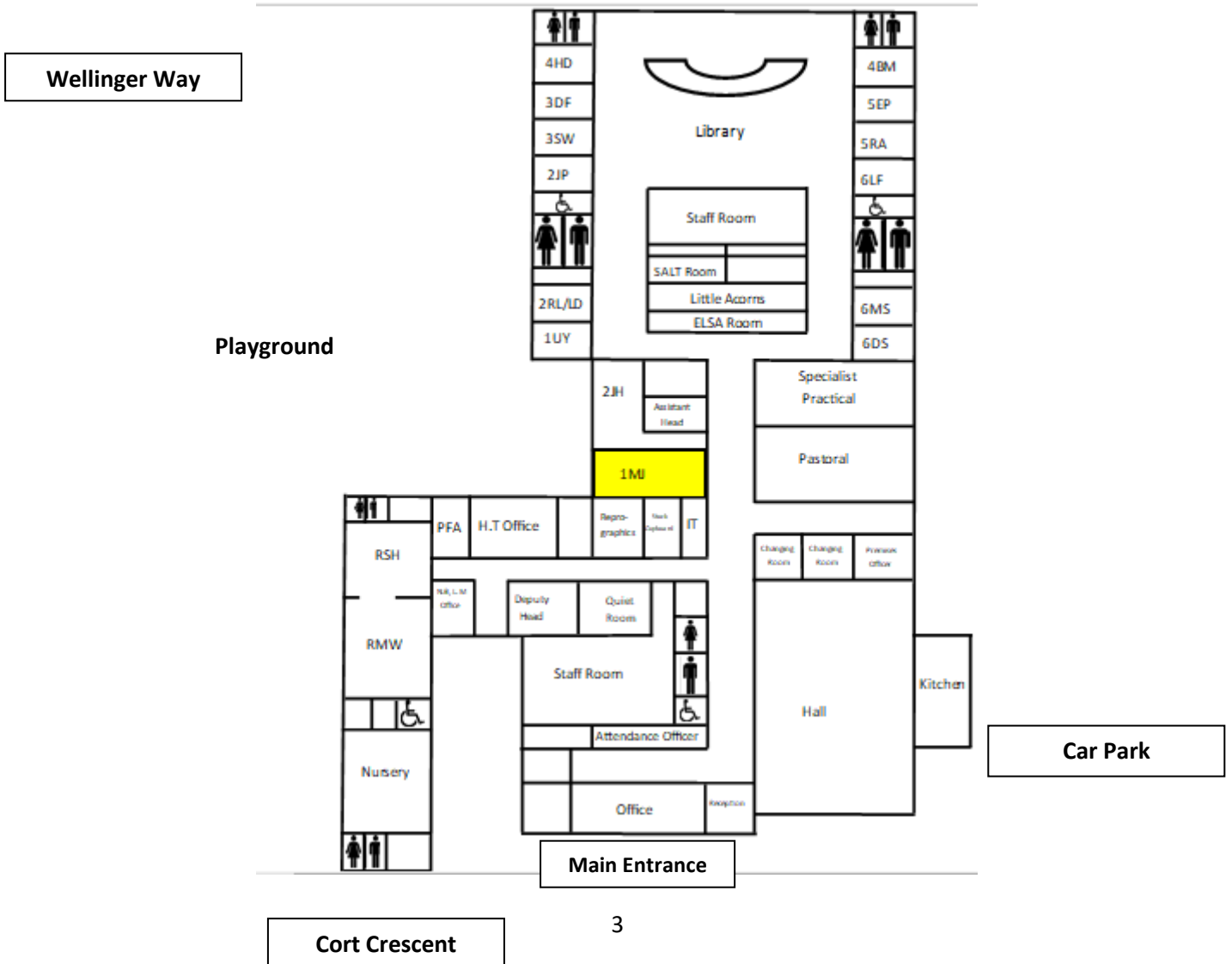

## **In school**

- Where possible, adults will support the children by keeping them in their year group bubbles with limited crossover.
- If a pupil requires intimate care, PPE will be worn.
- Classrooms will be well ventilated with doors and windows left open, wherever possible.
- Classroom furniture will be laid out in rows so that children are facing the front and that staff are at an adequate distance from the children.
- Children will sit in the same seat throughout the day. Coats to be hung up on pegs and packed lunches stored in the classrooms.
- Children can only bring in a bottle for water/squash which must be named and a healthy snack.
- Children can bring bookbags and they must be allocated reading books by the teachers. Any returned books are to go in the donning/doffing box and be left (clearly labeled) for 72 hours.
- On PE days, children will either wear their PE kit all day or wear their uniform with appropriate footwear. There will be no changing.
- Children will be provided with their own named pencil case and stationery.
- All unnecessary furniture and equipment will be moved from the classrooms.
- All equipment used – both outside and in the classrooms – will need to be cleaned regularly and be part of the staff's daily routine.
- Children are to use the one-way system in school at all times.
- There will be no after school clubs when we return; however, we will review this in the summer term after we have further guidance.

## **Toilets**

Years 5 and year 6 classrooms to use the Upper key stage two toilets between 6LF and 6DS

Years 3 and year 4 classrooms to use the Lower Key stage two toilets next to 4BM and 4HD

Years 1 and year 2 classrooms to use the KS1 toilets between 2RL/LD and 2JP

Nursery and reception classes to use own toilets.

Playtime and lunchtime the children will use their allocated toilets – staff will be on duty to monitor this.

If a pupil requires close medical or intimate care, PPE will be worn. Each classroom will be provided with a PPE Pack – containing Gloves, Apron and Mask – used only if needed – they are in labelled cupboards in each classroom.

## **Movement Around School**

- All non-essential movement around the school will be avoided.
- All staff are expected to wear face masks when travelling around the school (unless they are medically exempt).
- Some areas of the school will be marked with appropriate direction (one way) and no-entry signage.
- Where possible, children will be supervised in corridors and the main areas of the school to manage the number of children in these spaces.
- Groups of children will not mix outside of their year groups.
- Where possible (in accordance with fire regulations), doors will be propped open to reduce contact with door handles.
- Fire procedures have been reviewed and practices with children at the start of the reintegration period will take place.

## Break Times and Lunch Times

All children will be given morning breaktimes and lunchtimes in their year group bubbles. The field will be in use if it is not wet.

Breaktime				Lunchtime - Outside Play				
Playground	10.00 - 10.20	10.25 - 10.45	10.50 - 11.10	Playground	11.30 - 12.00	12.00 - 12.30	12.35 - 13.05	13.10 - 13.40
Top			Year 6	Top				Year 6
Lower			Year 5	Lower				Year 5
Top		Year 4		Top			Year 4	
Lower		Year 3		Lower			Year 3	
Top	Year 2			Top		Year 2		
Lower	Year 1			Lower		Year 1		
EYFS	Own playground used throughout the day			EYFS	F2			
F1 area	Own playground used throughout the day			F1 area	F1			

- Each group of children will have access to a limited range of equipment that will be wiped down after each use.
- Children will be reminded to wash their hands before they eat their lunch and at the end of each breaktime period before going back into the classrooms.
- First aiders are available for each breaktime and lunchtime session.

### Breakfast Club

Breakfast club will not be delivered in the traditional sense (at this moment in time) we will continue to provide toast in the morning. However, we will be reviewing breakfast club arrangements for the summer term.

### Lunchtime

- Children that bring in their own packed lunch will eat in their classroom and will be socially distanced. They will be supervised by an adult at all times.
- Children will all wash their hands before and after lunch.
- Children who order a lunch from school will eat in the hall in a designated area for their year group bubble. Children will be socially distanced and supervised by an adult at all times.
- All tables will be cleaned with disinfectant between different year group sittings.

**Actions if a pupil or staff member shows COVID-19 symptoms**



Pupil or staff member displays COVID-19 symptoms.



Isolated in an identified room within school.



Send home and advise to self-isolate for 10 days.  
Household members should self-isolate for 10 days. Encourage to get tested.



If test is negative, return to school and household ends self-isolation.  
If test is positive, move to 'confirmed case' scenario.

**Actions if there is a confirmed case of COVID-19 in a school**



Pupil or staff member tests positive for COVID-19.



Public Health England are contacted for advice.



Close contacts are made aware and told to isolate for 10 days.

Communication is sent to parents and staff as needed.

...